

NEW RELEASE

HIFLO PERFORMANCE INJECTORS

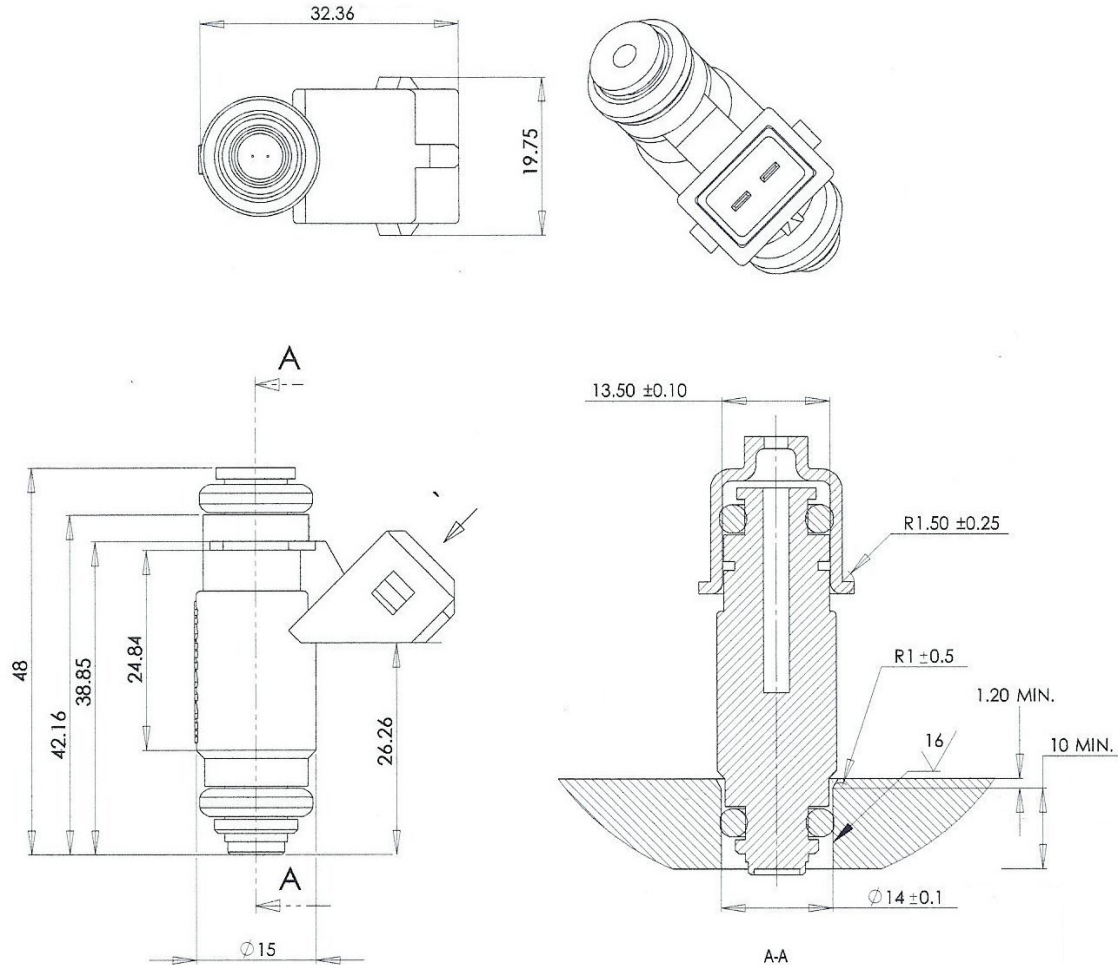

NOTES:

1. BEFORE ASSEMBLING INJECTOR TO RAIL AND MANIFOLD, THE TWO EXTERIOR O'RINGS MAY BE LIGHTLY COATED WITH ENGINE OIL. THE REST OF THE INJECTOR SHOULD BE KEPT CLEAN.
2. DO NOT USE SILICONE OILS OR LUBRICANTS FOR ASSEMBLY
3. THE INSTALLATION MUST ENSURE THAT THERE IS NO METAL CONTACT BETWEEN THE INJECTOR AND MOUNTING SURFACES
4. THE INJECTOR MUST BE INSTALLED IN THE VEHICLE SUCH THAT THE INLET IS HIGHER THAN THE NOZZLE.

CALIBRATION INFORMATION:
Static Flow: 10.7g/s @ 600 kpa
Impedance: 12 Ohms [High]
Gain: 110ms/mg
Offset: 0.55ms
Turn On Time: 1.14ms @ 14Vdc
Turn Off Time: 0.85ms @ 600 kpa

HIFLO FUEL INJECTION
FACTORY 4, 12-14 REGAL DVE
SPRINGVALE, VICTORIA, 3171
Website: www.hiflo.com.au



Phone: (03) 9547 9222
Fax: (03) 9546 3279
Freecall: 1800 817 006
Email: hiflo@hiflo.com.au